

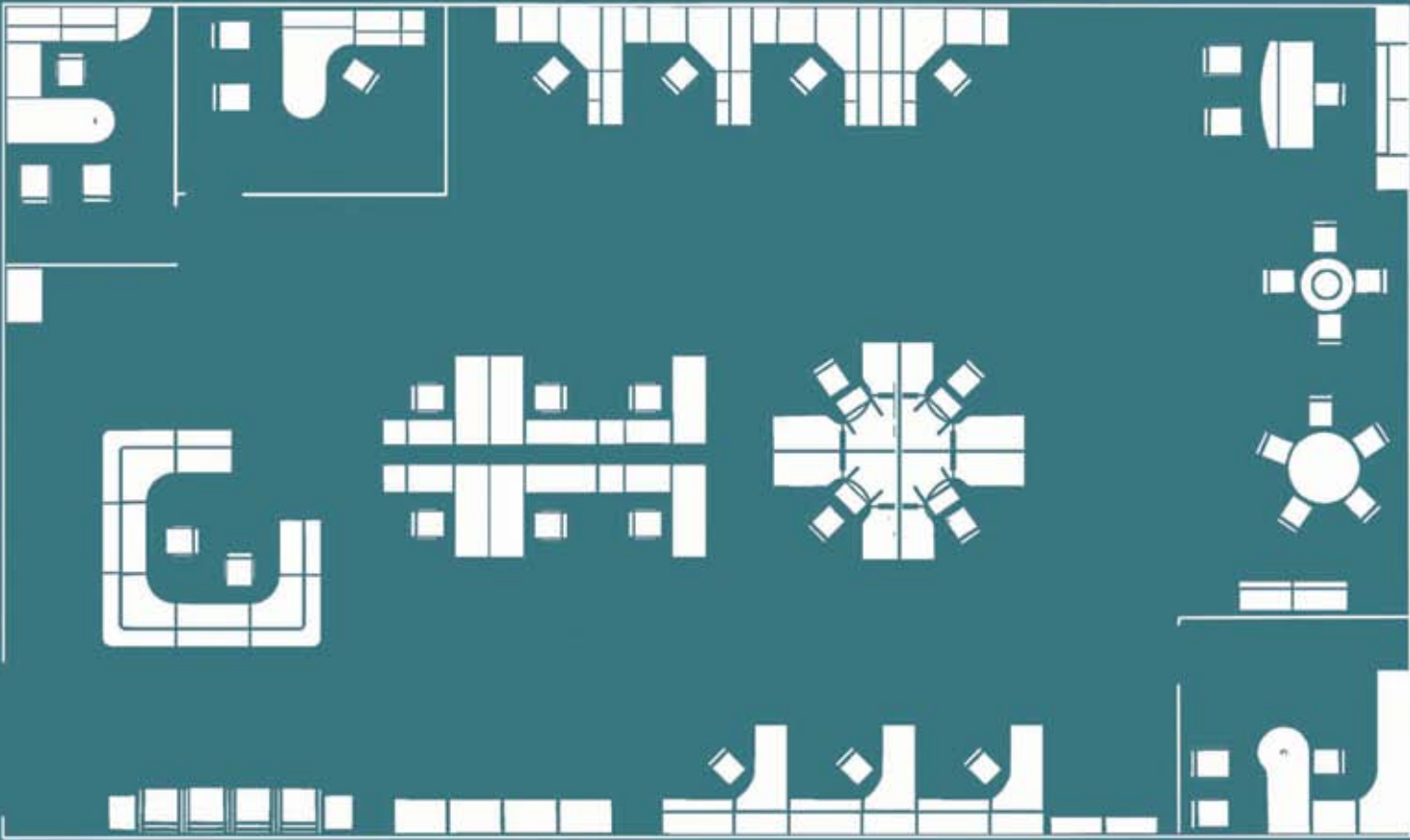

**INTERLINKS - TLC**  
CREATIVE SOLUTIONS

# THE INDUSTRY LEADER



## LINKS CREATIVE SOLUTIONS

Our design staff expertly utilize the 20-20 Giza Studio program to design, organize, and personalize your office with use of the Links Library containing over 4,000 sku's.

Giza studio uses a combination of scalable 2D and 3D drawings while generating expert reports for formal presentations. Our extensive service will increase the accuracy of your project.

*Links Contract Furniture Inc. is a manufacturer of high quality office furniture with experience in creating high performance workplace environments that have inspired, challenged, and adapted to the changing needs of its consumers since 1995. At Links Contract Furniture Inc. we embrace research and design - bringing innovative ideas, products, and services to the North American office furniture market.*

Ami Spector  
President



ANSI/BIFMA X 5.5-2008



Links Contract Furniture Values

We value our customers. We are responsible to the consumers who use our products. Therefore, in meeting the needs of our consumers we are committed to delivering the upmost quality products and providing business excellence as the of our consumers we are committed to delivering the upmost quality products and providing business excellence as the base of everything we do. We promise to listen closely to the needs of our consumers and strive to continuously exceed expectations.

At Links we recognize our members. An organization is only as effective as it's people. Therefore, employee development is an essential element of company growth. As an organization we believe in the ability of our people and stand behind them in achieving their greatest potential.

We value integrity. We believe in developing integrity in the deepest layers of our organization and not just at its surface. We strive to build mutually beneficial relationships with our customers, dealers, and suppliers as a foundation for growth.

We value continuous learning. We believe in growth through experience. A constant evolution in the way we think and act brings about new knowledge and skills that allow us to develop improved processes, advanced designs, and reduce our environmental impact.

We value our world. We work to cultivate the world in which we live in through investing in our people and the pursuit of sustainable development. Focusing our value chain on the challenges of sustainable development has allowed us to new ways to minimize our impact on the environment.

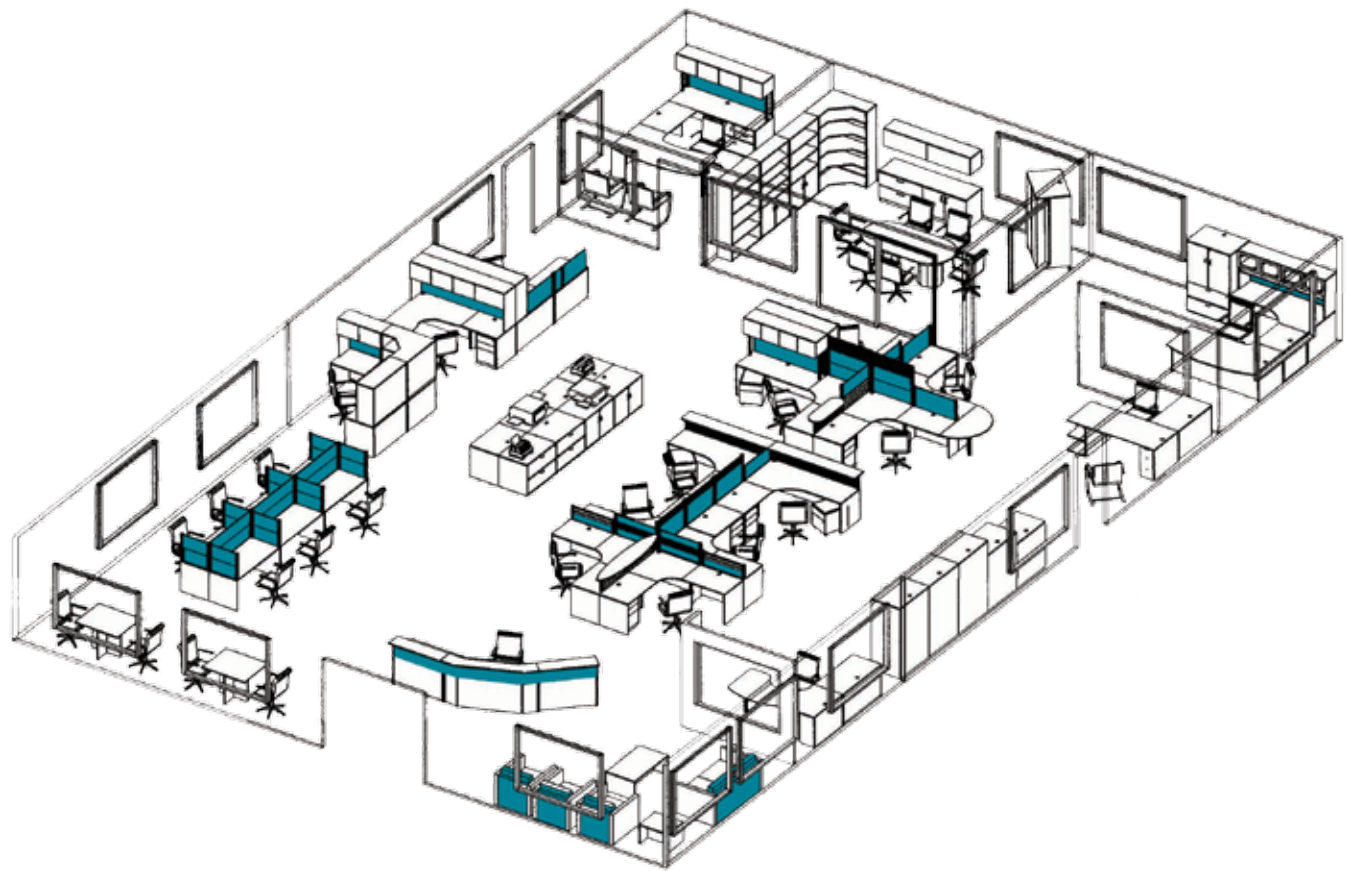

TABLE OF CONTENTS

President's Message	3
Modular Desking Systems	6
Private / Executive Offices	22
Reception Galleries	30
Storage Solutions	40
Carrels / Call Centers	44
Electrical Wire Management System	46
Grouping / Specifications	48
Laminates	56
Panel Inserts / Handles / Edging / Door Options	57
Environmental Responsibility	58







# DESKING SYSTEMS

CREATE A WORKSPACE  
TAILORED TO YOUR  
ENVIRONMENT.



Wall Mounted Hutch



Cushioned Pedestal



Silver Handles with  
Glazed Insert Framed  
Doors

The LINKS current profile is designed for open office applications and a shared workspace. This is ideal for the creation of unique design areas personalized to your style. The Links Made-To-Measure option is collaboration made easy.

**PS 730**  
Featured in Nutmeg (NM)  
With Glazed Doors (SZ)





LINKS LAMINATE COLLECTION CAN CREATE UP TO 225 DIFFERENT COLOR COMBINATIONS. AVAILABLE WITH OPTIONAL BLACK OR ALUMINUM POSTS AND FRAMES, NUMEROUS TEXTILES FOR TACKABLE PRIVACY PANELS PLUS NUMEROUS HANDLE OPTIONS.

Creativity, organization and ample storage create an efficient work environment. This featured U-Grouping offers privacy, plenty of workspace and storage with the overhead hutch, a mobile box/box/file pedestal, an optional three drawer lateral with locking door storage cabinet, a paper manager and an optional 29" high corner bookcase.

**PS315**  
Featured in True White (TW) over Chocolate Walnut (CW)



Curved Keyboard  
Corner Unit



Overhead Post  
Mounted Hutch



Crystal Glazed  
Privacy Panels



Paper Manager



DESKING SYSTEMS

THE FEATURED LINKS WORKSTATIONS INCORPORATE THE COMPATIBLE LINKS POST MOUNTED PRIVACY PANELS, WITH MULTIFUNCTIONAL USE OF TACK BOARDS, FOR A LEVEL OF PRIVACY FROM 6" TO 36" HIGH.

**PS350**  
Featured in True White (TW)  
over Chocolate Walnut (CW)



LINKS designed a work system which combines contemporary design and ergonomics, offered in a magnificent selection of beautiful finishes and textiles to enhance every workspace environment.





## DESKING SYSTEMS

THE SIGNATURE CREATION OF LINKS WITH THE FLEXIBILITY OF THE INTER-LINKS SYSTEM ALLOWS YOU TO CREATE INNOVATIVE WORK STATIONS TO MEET THE REQUIREMENTS FOR A MULTITUDE OF WORK ENVIRONMENTS.

GLAZED PARTITIONS, AVAILABLE IN TWO FINISHES AS WELL AS FROSTED. PROVIDE PRIVACY WHILE ALLOWING FOR ACCESS TO NATURAL LIGHT.



Glazed partitions available in two finishes provide partial privacy while allowing access to natural light. Tackable fabric partition tiles separate workstations in addition to providing privacy. The LINKS professional design team is available to assist with your space planning requirements.

### PS 715

Featured in True White (TW) over Chocolate Walnut (CW)





# DESKING SYSTEMS

THE GOAL OF SEAMLESS INTERACTION  
WITHIN A WORKING ENVIRONMENT IS  
MET WITH LINKS CONTRACT MODULAR  
DESKING SYSTEMS.

Elevate aesthetics and functionality and facilitate a team of  
individuals to work within close proximity, while maintaining a  
workspace that can be individualized and productive.

## PS 350 (X2)

Featured in True White (TW) over Chocolate Walnut (CW).







## DESKING SYSTEMS

PRESENTING THE EVOLUTION OF A DOUBLE WORKSTATION, DESIGNED TO FACILITATE SOLUTIONS FOR THE MODERN COLLABORATIVE WORKPLACE ENVIRONMENT.

THE AVANT-GARDE DESIGN IS AVAILABLE IN A WIDE RANGE OF FINISHES FULLY CUSTOMIZED ACCORDING TO CLIENTS' TASTES, COMPLEMENTED WITH CREDENZAS, STORAGE CABINETS, AND WALL UNITS.

### PS 735

Featured in True White (TW) over Chocolate Walnut (CW).







# DESKING SYSTEMS

INTRODUCING AN ATTRACTIVE AND INNOVATIVE DESIGN ON COLLABORATIVE WORKSPACE, LINKS SOPHISTICATED POST AND PANEL BASED DOUBLE DESKING SYSTEMS PROVIDE PRIVACY AND AMPLE OVERHEAD STORAGE SPACE.

The large expanse of continuous workspace is ideal, allowing maximum views and interaction amongst co-workers, while a shared island promotes collaborative meetings.

**PS 720**  
 Featured in True White (TW) over Chocolate Walnut (CW)





PRIVATE/EXECUTIVE  
OFFICE

COMBINING SUBSTANCE WITH THE SLENDERNESS OF MINIMALIST STYLING, DESIGNED FOR HIGH CLASS ENVIRONMENTS TO CHARACTERIZE AN EXTREMELY CLEAN AND STRONG PERSONALITY.

PS 740

Featured in True White (TW) over Chocolate Walnut (CW).



Optimizing the “Open Office” concept while maximizing storage.

Bookcases, Lateral File Drawers, Box and File Drawers, Paper Managers, Hutch Storage, Wardrobe Storage - every possible storage option while conveying an aura of open workspaces.





THE FEATURED LINKS COLOR COMBINATIONS OF TWO PURE COLORS, BLACK AND WHITE, CREATE A STRONGLY MARKED PERSONALITY WITH AN INTRIGUING EFFECT TO ALLOW ORIGINAL AND VISUALLY APPEALING FURNISHING SOLUTIONS.

**PS 340**  
 Featured in True white (TW) over Black (BK).  
 Shown with Corner Bookcases,  
 Post Mounted Hutch, Credenza and Desk.







# PRIVATE/EXECUTIVE OFFICE

## PS 316

Featured in Chocolate Walnut (CW).  
Shown with LMFC cabinet.



LINKS CONTRACT FURNITURE OFFERS THE IDEAL SOLUTION AND A PERFECT CHOICE FOR AN EXECUTIVE. LINKS COMBINES BEAUTIFULLY COORDINATED STORAGE, MEETING TABLES, AND DESKS FOR FLEXIBLE OFFICE REQUIREMENTS.

DESIGNED MODULAR SYSTEM COMPONENTS CAN BE EASILY ARRANGED TO SUIT EITHER INDIVIDUAL WORKING ROOMS OR GROUP MEETING AREAS, MAKING IT IDEAL FOR MANAGERIAL AND EXECUTIVE OFFICES.

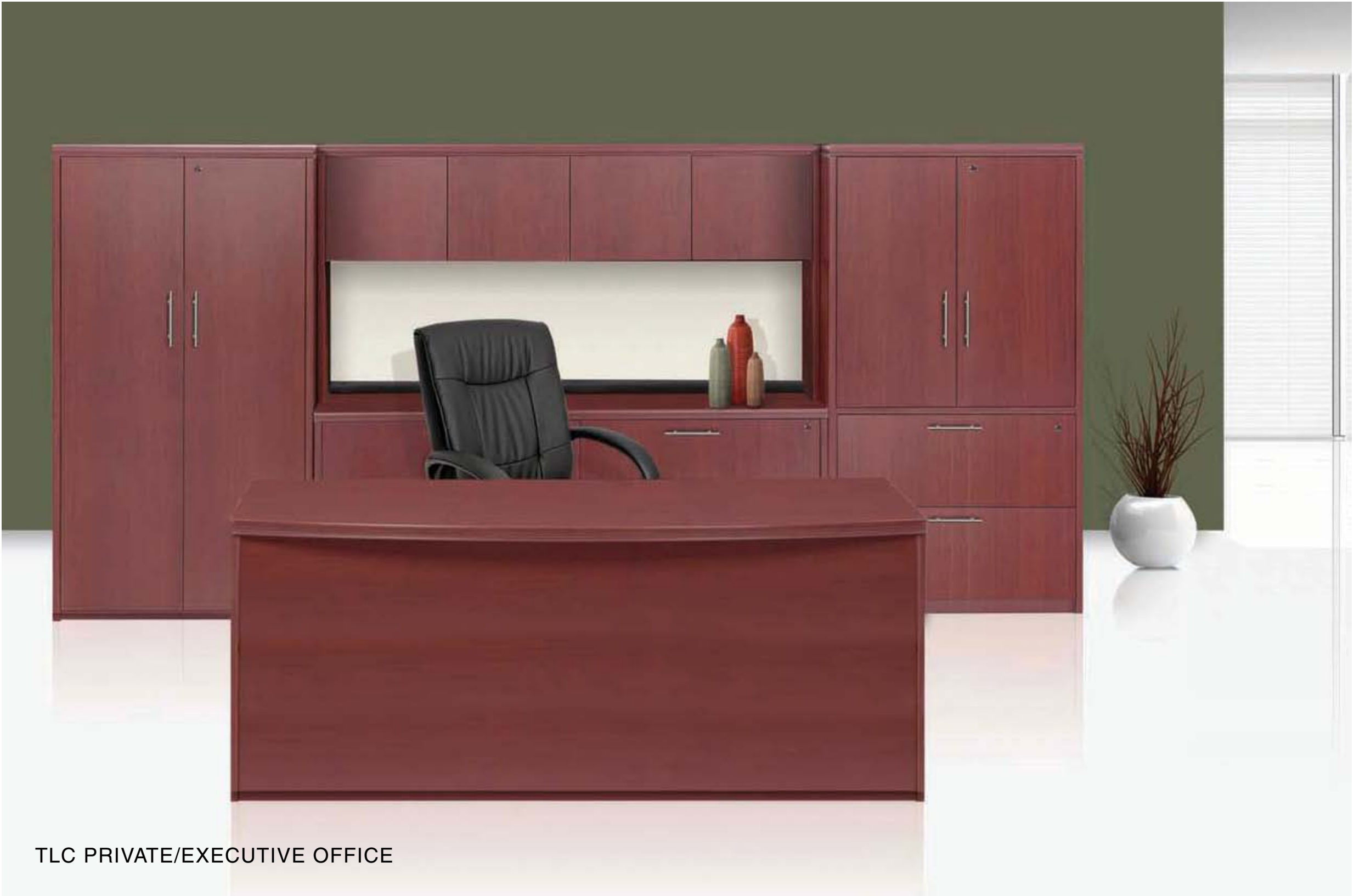

## TLC PRIVATE/EXECUTIVE OFFICE

THIS VERSATILE ELEGANT EXECUTIVE DESK SERIES WITH LINKS TLC DESIGN EDGING IS A COMPOSED OFFERING OF SYMMETRIC DESIGNS. EXECUTIVE SERIES ENHANCES A USER'S DAY-TO-DAY WORK EXPERIENCE THROUGH A VARIETY OF DESK SHAPES AND A MULTITUDE OF FUNCTIONAL OPTIONS. THIS USER-ORIENTED APPROACH TO DESIGN INSPIRES INNOVATIVE FUNCTIONS SUCH AS OFF-MODULAR WORK TOOLS AND TOOL DRAWERS TO STORE FREQUENTLY USED ITEMS WITHIN IMMEDIATE REACH.

### PS 365

Featured in Cherry Henna (CH)  
Features TLC Basic Edge



Available with Optional  
TLC 1 Basic Edge Design.  
3mm "Tough Guard" edging,  
tops are 1.5"/38mm  
thick profile.







TLC PRIVATE/EXECUTIVE OFFICE

LINKS TLC FURNISHING SOLUTIONS FOR TOP EXECUTIVE ENVIRONMENTS WITH SOLID 1.5" THICK TOPS. PRESTIGE IS FULLY EXPRESSED IN THE DESIGN. WITH COMPOSED ELEGANCE, LINKS ADDS FUNCTIONALITY AND PRACTICAL VERSATILITY, ESSENTIAL ELEMENTS IN AN EXECUTIVE ENVIRONMENT.

**PS 360**  
 Featured in Chocolate Walnut (CW)  
 Features TLC Basic Edge  
 With Vertical Lateral File/Storage Cabinet and Wardrobe Cabinet.



Available with Optional  
 TLC 1 Basic  
 Edge Design.  
 3mm "Tough Guard" edging,  
 tops are 1.5"/38mm  
 thick profile

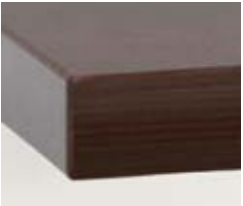



6" Dropped Transaction Top



TLC Edging



6" Counter Top on Credenza

## TLC RECEPTION GALLERY

THE LINKS RECEPTION GALLERY IS A COMBINATION OF SIMPLICITY AND GRACE, WITH AN ATTRACTIVE DESIGN THAT WILL IMPRESS VISITORS WITH AN INVITING WELCOME.

### PS 510

Featured in Cherry Henna (CH) over Willow Gray (WG).  
Features TLC Basic Edge Detail.







## RECEPTION GALLERY

MAKE A GREAT FIRST IMPRESSION. LET VISITORS SEE WHO YOU ARE AND WHAT YOU STAND FOR. WHATEVER YOU WANT TO SAY, THE LINKS RECEPTION DESK WILL SAY IT FOR YOU.

The LINKS Reception Gallery greets guests and clients with sophistication.

### PS 320

Featured in True White (TW) over Chocolate Walnut (CW)



## RECEPTION GALLERY





6" Dropped Transaction Top

Optional Mobile Pedestals

Wall Mounted Cabinet



## RECEPTION GALLERY

LINKS RECEPTION GALLERIES OFFER AN INTELLIGENT AND EFFECTIVE SOLUTION FOR OFFICE ENTRANCE AREAS.

### PS 656

Featured in Riviera Maple (RM) over Chocolate Walnut (CW).  
With Wall Mounted Cabinet shown.







# RECEPTION GALLERY

PROMOTE EFFECIENCY AND PROJECT A PROFESSIONAL IMAGE FOR GREETING GUESTS IN ALL OFFICE ENVIRONMENTS.

The LINKS Reception Desk is refined, sophisticated and functional.

**PS 600**  
 Featured in Storm Gray (SG) over Willow Gray (WG).  
 Optional Bookcases with extensions shown.



Shown with Crystal Glazed Panel Inserts



Shown with 6" and 12" Transaction Counters



Shown with Mobile Pedestals



## RECEPTION GALLERY

CLEVER DESIGN INCORPORATES UNDENIABLE STYLE AND DESIRABLE CONVENIENCE. LINKS RECEPTION COLLECTIONS ARE AVAILABLE IN NUMEROUS CONFIGURATIONS AND UP TO 225 LAMINATE COLOUR COMBINATIONS TO SUIT YOUR SPACE AND DESIRED ATMOSPHERE.

### PS 95

Featured in Nutmeg (NM).  
Shown with optional Corner Bookcase  
Square Bookcase and  
Display Cabinets.



Shown with Glazed Panel Inserts



Privacy/Tackboard Inserts



Shown in Storm Gray (SG) over Nutmeg (NM)

The complement of matching bookcases and storage cabinets adds that final touch to your corporate image.





# COLLABORATIVE STORAGE SOLUTIONS

THE COMPLETE STORAGE LINE  
CREATES MODULAR ZONES OF  
ORGANIZATION, STORAGE AND  
DISPLAY.

LINKS credenzas with stacker storage units are ideal for space partitions in open plan designs. Our Collaborative Storage units offer an up-to-date design for your private office environment.

**PS 721**  
Featured in True White (TW) over Chocolate Walnut (CW).



Adjustable Shelf Dividers



Adjustable Shelves in  
Corner Units



Optional Task Light



ESSENTIAL OPTIONS FROM LINKS CONTRACT FURNITURE OFFERS PRACTICAL AND INTELLIGENT STORAGE SPACE THAT WILL MAKE THE VERY MOST OF YOUR DECOR.

WHETHER YOU ARE LOOKING FOR LATERAL FILES, STORAGE UNITS, BOOKCASES, DISPLAY CASES, OR PEDESTALS, LINKS' ESSENTIAL OPTIONS PROVIDES ABSOLUTE FREEDOM OF EXPRESSION.





CARRELS

LINKS STC AND STX SERIES CARRELS ARE IDEAL FOR LIBRARIES, STUDY HALLS, COMPUTER LABS AND CALL CENTERS ANYWHERE PRIVACY IS REQUIRED. THE LINKS CARREL SERIES IS DESIGNED TO PROVIDE THE ABILITY TO CREATE CUSTOMIZED ROWS OF PRIVATE DESKS IN LIMITED SPACE.

STC SERIES

Featured in Willow Grey (WG) over Cognac (CO).

FEATURES

- Manufactured for ease of full wire accessibility with grommets on work surface, side and back panels.
- Concave work surface for ergonomic study comfort.
- Shelf 8in deep with optional task light to provide brighter work area (mounted under shelf).
- Panels designed for ample leg room.

OPTIONS

- Tack Board with various fabric options.
- ACC-LTL 24 Tack Light (mounted under shelf) - 36in width top.
- ACC-LTL 36 Tack Light (mounted under shelf) - 42in width top.
- Electrify workstations with our PAK 8 System power distribution components - UL AND CSA Certified.



# ELECTRICAL WIRE SYSTEM

Pre-wired electrical system part of Links Furniture System



Let our team assist you with your electrical requirements, as well as, provide 2D & 3D drawings from our Design Department.



Economical power in a compact, easy to install unit.



[C] Ceiling / Base Feed Hardware  
Used to introduce power to the electrical system

[A] J Channel Assembly shown with optional RJ11 / RJ45 Communication connectors

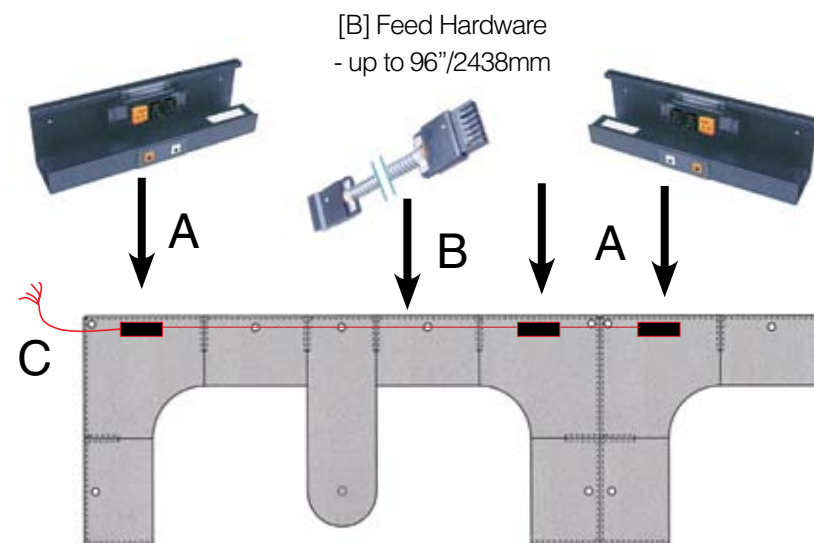

## FEATURES

The optional pre-wired electrical system is offered by Links Contract Furniture and consists of the following features:

- connect any combination of standard equipment such as task lights, RPC retractable power centers, business machines and computer equipment from one assembly.
- shielded isolated circuit provides a barrier against electromagnetic interference.
- multi-station capabilities with interconnecting cable and large volume snap-in voice/data communication connectors (RJ11 / RJ45).
- specially designed metal flex cables and heavy gauge steel wire management.

## POWER DISTRIBUTION COMPONENTS



### J CHANNEL

Heavy gauge steel wire management. Large volume snap-in voice/data section for communication connectors (RJ11/RJ45).



### POWER MODULE

Multi-circuit which allows for multi station use with interconnecting cable. Snap-in receptacles permit an assortment of circuit designations.

### BASE FEED HARDWARE (BFH)

The most common solution to wiring the Links PAK-8 system to the building. It brings power to all 4 circuits in the module. The BFH is wired to the building supply at floor level by a licensed electrician.

### CEILING FEED HARDWARE (CFH)

Used to introduce power to the electrical system and energize the first power module from the ceiling electrical source through a power pole or wall box where local codes permit. It gives power to the receptacles and the CFH comes in 13 foot lengths.

## METAL FLEX CABLES

### METAL FLEX CABLES: FEMALE BOTH ENDS

Connects from power module to power module. Lengths available: 24"/610mm, 36"/914mm, 48"/1219mm, 60"/1524mm, 72"/1829mm, 84"/2137mm, 96"/2438mm

### METAL FLEX CABLES: FEMALE END/MALE END

Used in directional systems as an extension or pass through from female cable to power module.

## SPECIFICATIONS FOR ELECTRICAL SYSTEM

The pre-wired electrical system which is considered part of the Links Furniture System will consist of the following:

The four circuit, 8-wire system offers three standard circuits using a common neutral and ground, and the fourth circuit which is an isolated circuit, having a separate neutral and an isolated ground, plus a shielded metallic barrier against Electromagnetic interference (EMI).

The power block shall have four simplex receptacles, and are mechanically interchangeable to permit the use of any combination of standard equipment such as task lights, Links ROC retractable power centers and business machines other than computer equipment.

The removal of the simplex receptacle is accomplished by the use of a special tool which restricts the modification of the system to authorized personnel only. Simplex receptacles are coded as Circuit #1 I.D. with the numeral 1 on the simplex receptacle which shares a common neutral and ground with circuit #2 and #4.

The isolated circuit #3 is a dedicated circuit that has a separate neutral and isolated ground not shared by the other three circuits. The simplex receptacle is identified with "IG" on a solid NEMA orange color. The circuit is also shielded from circuits #1, #2 and #4 to eliminate (EMI). The simplex "IG" should be reserved for applications requiring a dedicated circuit such as computer equipment.

The electrical system shall bear the recognition symbol issued by Underwriter's Laboratories, Inc. and Canadian Standards Association and shall be constructed in accordance with the latest issue of the National Electric Code set by the Power Commission in your area.



SPECIFICATIONS



PS 730 Page 6

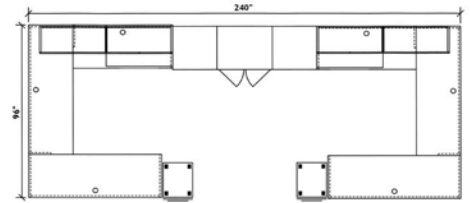

PS 315 Page 8



PS 350 Page 10

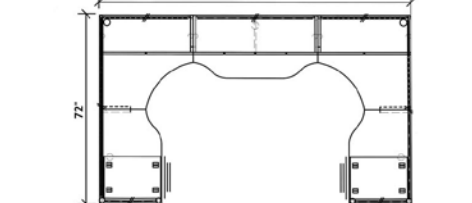

PS 316 Page 24

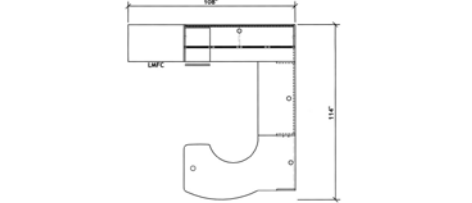

PS 365 Page 26

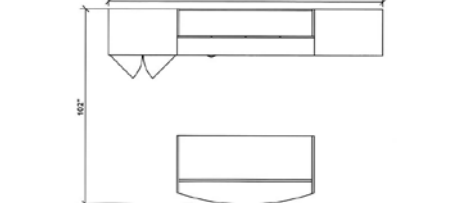

PS 360 Page 28

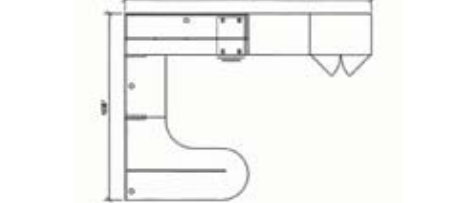

PS 715 X 3 Page 12

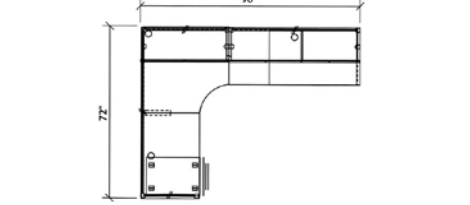

PS 350 X 2 Page 14

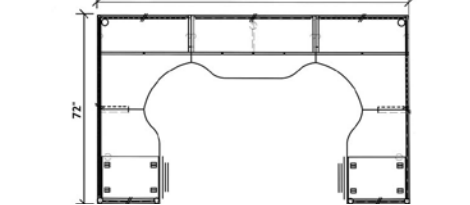

PS 735 Page 16

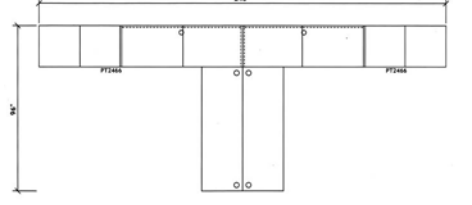

PS 510 Page 30

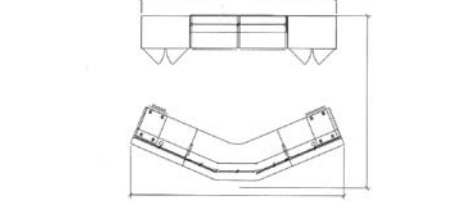

PS 320 Page 32

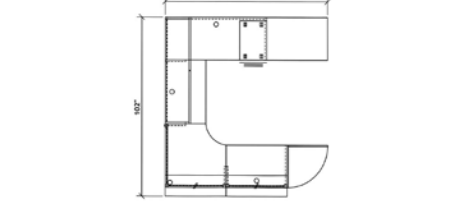

PS 656 Page 34

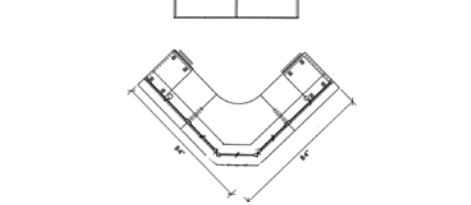

PS 720 Page 18

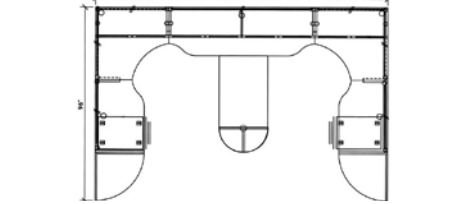

PS 740 Page 20

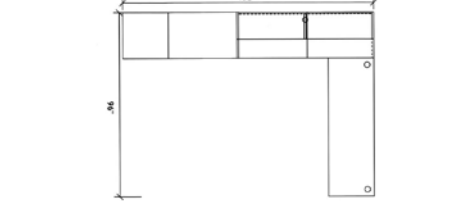

PS 340 Page 22

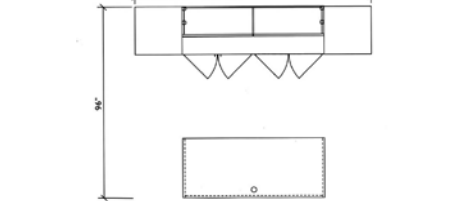

PS 600 Page 36

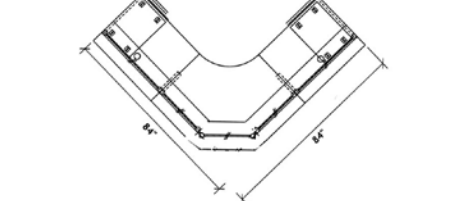



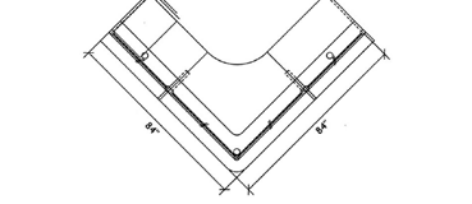



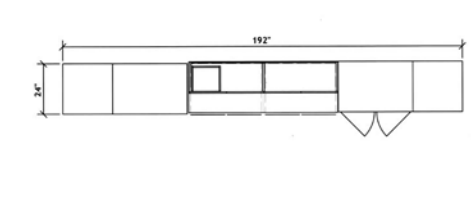



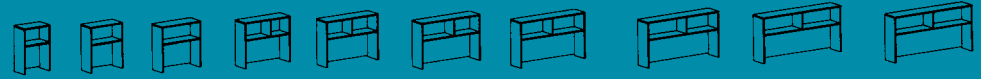

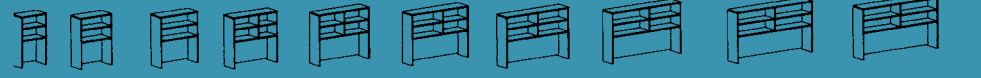

PS 95 Page 38



PS 721 Page 40



SPACE SOLUTIONS - HUTCHES

36" High Freestanding Hutches		24, 30, 36, 42, 48, 54, 60, 66, 72, 78" wide
36" High Freestanding Hutches with Organizer Shelf		24, 30, 36, 42, 48, 54, 60, 66, 72, 78" wide
42" High Freestanding Hutches		24, 30, 36, 42, 48, 54, 60, 66, 72, 78" wide
42" High Freestanding Hutches with Organizer Shelf		24, 30, 36, 42, 48, 54, 60, 66, 72, 78" wide
50" High Freestanding Hutches		24, 30, 36, 42, 48, 54, 60, 66, 72, 78" wide
50" High Freestanding Hutches with Organizer Shelf		24, 30, 36, 42, 48, 54, 60, 66, 72, 78" wide
38" High Post Mounted Hutches		24, 30, 36, 42, 48, 54, 60, 66, 72" wide
38" High Post Mounted Hutches with Organizer Shelf		24, 30, 36, 42, 48, 54, 60, 66, 72" wide
14" High Wall Mounted Hutches		24, 30, 36, 42, 48, 54, 60, 66, 72" wide
20" High Wall Mounted Hutches with Organizer Shelf		24, 30, 36, 42, 48, 54, 60, 66, 72" wide
36" High Freestanding Corner Hutches		36 x 36   42 x 42   48 x 48" wide
42" High Freestanding Corner Hutches		36 x 36   42 x 42   48 x 48" wide
38" High Post Mounted Corner Hutches		36 x 36   42 x 42   48 x 48" wide
38" High Post Mounted Corner Hutches with Organizer Shelf		36 x 36   42 x 42   48 x 48" wide
14" , 21" and 27" High Paper Managers		16" wide



STORAGE/SPACE SOLUTIONS - HUTCHES





## Rectangular Freestanding Desks

24 and 30" deep
24, 30, 36, 42, 48, 54, 60, 66, 72" wide

## Bowed Tops

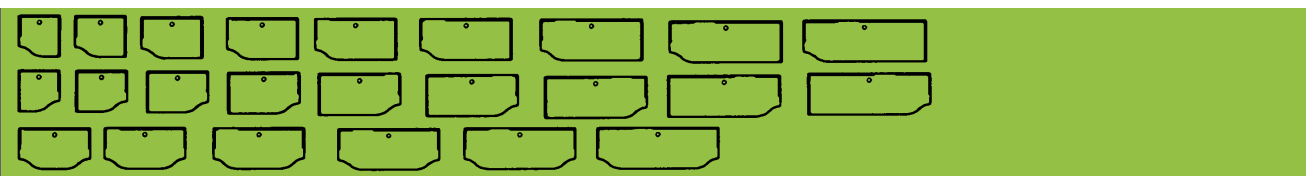

24/18" and 30/24" deep  
24, 30, 36, 42, 48, 54, 60, 66, 72" wide  
24, 30, 36, 42, 48, 54, 60, 66, 72" wide  
42, 48, 54, 60, 66, 72" wide

## Shaped Tops

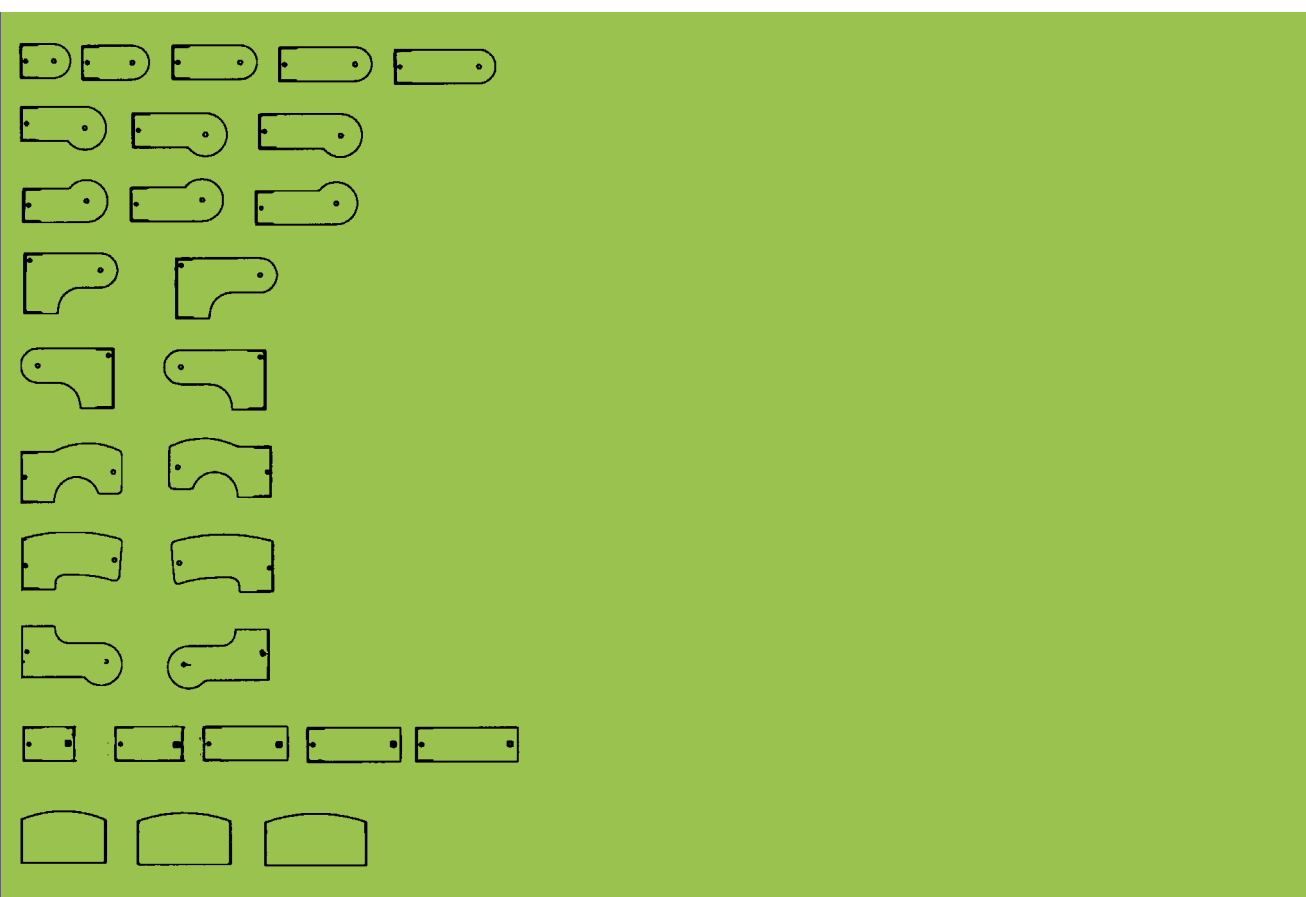

24 and 30" deep  
36, 48, 60, 66, 72" wide

24 and 30" deep  
60, 66, 72" wide

24/42" and 30/48" deep  
66, and 72" wide

24/42" and 30/48" deep  
66, and 72" wide

36/24/30" deep  
72" wide

36/30" deep

36/24" deep

72" wide

24 and 30" deep

36, 48, 60, 66, 72" wide

30/36" deep

60, 66, 72" wide

18, 24, 30" deep

# Corner Units

## Extended Corner Units

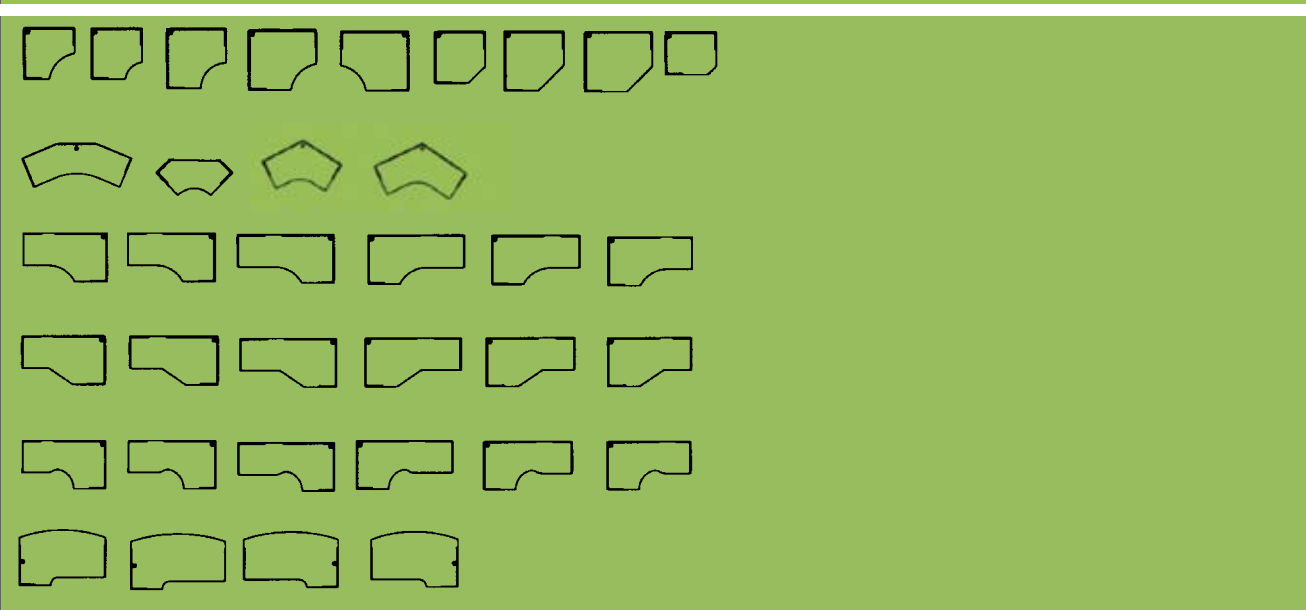

30, 36, 42, 48" wide

24 and 30" deep

36", 42" deep

36, 42, and 72" deep

60, 66, and 72" wide

36", 42" deep

60, 66, and 72" wide

36", 42" deep  
60, 66, and 72" wide

36", 42" deep  
66, and 72" wide

1. **Identify the problem.** The first step in the problem-solving process is to identify the problem. This involves recognizing the issue, gathering information, and defining the problem clearly.



## SPACE SOLUTIONS - DESK TOPS



Refer to LINKS PRICE LIST for complete details. 53

SPACE SOLUTIONS - CABINETS

29" High Pedestals  
Storage  
Lateral  
Combo Cabinets  
Corner Bookcases



36"/42" High  
Storage  
Lateral  
Combo Cabinets  
Corner Bookcases



55" High  
Lateral Cabinet



66" High  
Storage  
Lateral  
Combo Cabinets

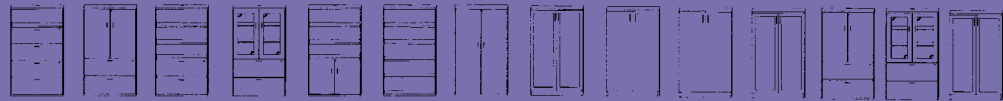

66" High  
Personal Wardrobe Towers  
Corner Bookcases



72" High  
Cabinets  
Bookcases



27" High  
Stack-On Cabinets  
Bookcases

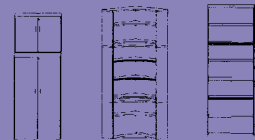

SPACE SOLUTIONS - CABINETS





LAMINATE OPTIONS

<div>Sahara (SA)</div> <div>Top/Base</div> <div>Interlinks/TLC/Bench</div>	<div>Cognac (CO)</div> <div>Top/Base</div> <div>Interlinks/TLC/Bench</div>	<div>Cherry Henna (CH)</div> <div>Top/Base</div> <div>Interlinks/TLC/Bench</div>	<div>Classic Mahogany (CM)</div> <div>Top/Base</div> <div>Interlinks/TLC/Bench</div>	<div>Chocolate Walnut (CW)</div> <div>Top/Base</div> <div>Interlinks/TLC/Bench</div>
<div>Riviera Maple (RM)</div> <div>Top/Base</div> <div>Interlinks/Bench</div>	<div>Willow Gray (WG)</div> <div>Top/Base</div> <div>Interlinks/Bench</div>	<div>True White (TW)</div> <div>Top/Base</div> <div>Interlinks/Bench</div>	<div>Gray (GR)</div> <div>Top/Base</div> <div>Interlinks/Bench</div>	<div>Storm Gray (SG)</div> <div>Top/Base</div> <div>Interlinks/Bench</div>
<div>Cappuccino (CP)</div> <div>Top/Base</div> <div>Interlinks/Bench</div>	<div>Nutmeg (NM)</div> <div>Top/Base</div> <div>Interlinks/Bench</div>	<div>Milky Way (MW)</div> <div>Top/Base</div> <div>Interlinks/Bench</div>	<div>Windy City (WC)</div> <div>Top/Base</div> <div>Interlinks/Bench</div>	<div>London Fog (LN)</div> <div>Top/Base</div> <div>Interlinks/Bench</div>
<div>Chamois Black (BK)</div> <div>Base</div> <div>Interlinks/Bench</div>	<div>Lime Burst (LB)</div> <div>Accent Only</div> <div>Doors/Drawers/Shelves</div>	<div>Aqua Breeze (AB)</div> <div>Accent Only</div> <div>Doors/Drawers/Shelves</div>	<div>Strawberry Fields (SF)</div> <div>Accent Only</div> <div>Doors/Drawers/Shelves</div>	<div>LINKS</div> <div>CONTRACT FURNITURE</div>

Finishes shown are as close to actual color as printing will allow. Every effort has been made to ensure consistency, however slight variations in color may occur.

PANEL INSERT - DOOR - EDGE - HANDLE - OPTIONS

<div>Crystal Insert - Aluminum Post (AL)</div>	<div>Glazed Insert - Aluminum Post (AL)</div>	<div>Black Slatwall Insert - Black Post (BK)</div> <div>Available in Aluminum</div>
<div>Fabric Insert - Aluminum Post (AL)</div>	<div>Whiteboard Insert - Black Post (BK)</div>	<div>Frosted Insert - Aluminum Post (AL)</div>
<div>Laminate Insert - Black Post (BK)</div>	<div>Glazed Door (SZ)</div>	<div>Laminate Door</div>
<div>INTER-LINKS</div> <div>3 mm "TOUGH GUARD"</div> <div>Edging, tops are 1in (25mm) thick</div>	<div>OPTIONAL TLC</div> <div>3 mm "TOUGH GUARD"</div> <div>Edging, tops are 1.5in (25mm) thick</div>	

PULL HANDLE OPTIONS

All handles are for use with: lateral files, storage cabinets and other items, such as pedestal and wardrobes

<div>STANDARD</div> <div>P1 Pull Handle</div> <div>Black Finish</div>	<div>OPTIONAL</div> <div>P2 Pull Handle</div> <div>Brushed Nickel Finish</div>	<div>OPTIONAL</div> <div>P3 Pull Handle</div> <div>Silver Finish</div>	<div>OPTIONAL</div> <div>P4 Pull Handle</div> <div>Brushed Nickel Finish</div>	<div>OPTIONAL</div> <div>P5 Pull Handle</div> <div>Brushed Nickel Finish</div>
	<div>OPTIONAL</div> <div>P6 Pull Handle</div> <div>Black Finish</div>	<div>OPTIONAL</div> <div>P7 Pull Handle</div> <div>Brushed Nickel Finish</div>		



# PRESERVING THE ENVIRONMENT FROM DESIGN TO DISTRIBUTION

## GREEN PLAN - MISSION STATEMENT

At Links Contract Furniture our Environmental Management has worked diligently for many years on waste reduction programs

### WHAT WE ARE CURRENTLY RECYCLING:

WOOD SCRAP	96%
CARDBOARD	96%
FINE PAPER	96%
STEEL	96%

The Environment is an issue taken most seriously. We demand it from ourselves and from our suppliers. Our objective is to be “My Earth - Friendly”, and to contribute to a “Green Future” by what we can accomplish today. The ultimate goal is to eliminate waste materials resulting from manufacturing, production and office operations.

Reducing the amount of packaging material used, begins with Links Contract Furniture’s packaging experts who ensure safe delivery of furniture and use the minimum amount of packaging material necessary. The highest possible percentage of recycled and recyclable material is used in our packaging materials.

### WASTE REDUCTION PLAN

- Reduce disposable packaging
- Use packaging materials that are recyclable
- Recycle solvents used in the manufacturing process
- Prevent, reduce, or eliminate manufacturing related emissions, known as volatile organic compounds; these chemicals are found in many paints, adhesives and cleaning solvents
- Work with suppliers worldwide to identify additional opportunities for implementing reusable packaging programs
- Extend life cycle by designing furniture to provide many years of service



ANSI/BIFMA X 5.5-2008



# PRESERVING THE ENVIRONMENT

LINKS CONTRACT FURNITURE INC. CURRENTLY RECYCLES 96% OF THE WASTE MATERIALS IT GENERATES EACH YEAR.

WE ARE CONTINUOUSLY LOOKING FOR NEW WAYS TO REDUCE, REUSE AND RECYCLE WASTE.

EVERY YEAR LINKS CONTRACT FURNITURE ADOPTS NEW TECHNOLOGIES THAT WILL DIVERT MORE WASTE AWAY FROM LANDFILLS AND TOWARD USEFUL APPLICATIONS.





Quality office Furniture. Products meet or exceed ANSI/BIFMA x 5.5-2008 Quality Standards.

While every effort was made to ensure the accuracy of information contained in this Pricing - Specification Guide at the time of publication, we cannot accept responsibility for inaccuracies resulting from printing errors or omissions. We reserve the right to make product improvements and price changes without notice.

© Copyright 2011 Links Contract Furniture, Inc. All Rights Reserved